

MSR   
**SEASONS**  
IT'S TIME FOR MORE

# IT'S TIME FOR MORE...



Exclusively marketed by **CBRE**

Site Address: MSR SEASONS, City Survey No. 3876, Opp Lokmanya Hospital,  
Near Chinchwad Railway Station, Udyog Nagar, Chinchwad, Pune - 411 033

Office Address: Amar Avinash Corporate City, 4th Floor, Above HSBC Bank,  
Near Inox Multiplex, Bund Garden Road, Pune - 411 001

© 99232 00751 / 52 | seasons@mindspace Realty.com

 This project registered via  
MAHARERA NO. P52100006114  
<https://maharera.mahaonline.gov.in/>

MEMBER OF  
**CREDITA**

 This property is mortgage to  
**CAPITAL INDIA FINANCE LIMITED.**  
NOC for individual sales will be  
provided on demand.

Disclaimer: This Brochure is not a legal offering. The developers  
reserve absolute rights to change/ cancel any plans, layout, no of  
floors and for specifications at their discretion. Images are for  
representational purposes only.

Project approved by all major banks

MSR   
**SEASONS**

---

IT'S TIME FOR MORE



**ABOUT  
THE PROJECT**

MSR Seasons hosts an array of 2 & 3 BHK homes that are crafted with happiness and surrounded by the enigmatic beauty of Nature. It is strategically located at the heart of Chinchwad, ensuring the availability of convenience at all times. Dwell in homes equipped with modern facilities, amidst a serene ambience that will rejuvenate you from within, everyday!

# MORE OF MERRY MOMENTS...

Just like the Summer season brings brighter and joyful days, Mindspace Realty Seasons brings to you homes with plush interiors amidst the lush green, located at the heart of Chinchwad. Every detail and amenities offer a life that is holistic and fullfilling just like every season has its own charm.

**Live in homes as splendid as Summers!**



# AMENITIES

- Grand Entrance Gate
- Children's Play Area
- Solar Water Heater
- Planned Parking
- Vastu Compliant Design
- Green Building Planning
- 100% DG Back up for Common Area
- Jogging Track
- Cricket Pitch
- Multi-Purpose Court
- Party Lawn



# MORE OF SERENE MOMENTS...

Just like Monsoon season enhances the beauty of nature, the specifications of the 2 and 3 bhk homes are carefully added to bring out the best of your dream home. Homes at Mindspace Realty Seasons is the perfect example of architectural brilliance wrapped with the nature's enigmatic beauty, offering unique homes to the customers.

**Live in homes as mesmerising as Monsoons!**



# SPECIFICATIONS

## Security:

- Round the clock security

## Living and Dining:

- Designer vitrified 2'x2' flooring
- Pop finished walls and ceiling
- Teakwood finish door frames
- UPVC windows

## Kitchen:

- Vitrified tiles in kitchen
- Premium ceramic tiles upto dado level
- Granite platform
- Stainless steel sink

## Toilets:

- Pressure tested concealed plumbing
- Good quality C.P. Fittings
- Anti-skid flooring and glazed tiles
- Bathroom with ceramic tiles

## Domestic Facility:

- Good quality electrical wiring and modular switches
- Piped gas supply
- Provision for DTH connection
- Solar water heating system
- Flush door shutters (internal)
- Grand entrance lobbies for each wing
- Apartments serviced by high-speed elevators

## Structure:

- Earthquake resistance RCC framed structure
- Power back up for common areas
- Fire fighting system / equipment





# MORE OF LIVELY MOMENTS...

Just like the Autumn season brings fun-filled days, Mindspace Realty Seasons has an array of thoughtfully picked amenities to give you memories that you can make with your loved ones. The long walking tracks fringed with trees, making every evening tranquil and peaceful. Let your kids play and experience the real joy of having a delightful childhood. Experience a lifestyle with an abundance of life.

**Live in homes as amiable as Autumn!**



# MIND SPACE REALTY, OFFERING MORE THAN JUST SPACES!

Mind Space Realty offers spaces that are designed with perfection and keeping every detail in mind. Every space is planned in a unique way, ensuring you are offered the maximum functionality. Its ambitious vision has helped them achieve architectural brilliance in their projects like MSR Queenstown in Chinchwad, MSR Olive in Katraj, MSR Capital in Pimpri, MSR Square in Chinchwad.

**MSR CAPITAL**  
THINKING SPACES

  
**QUEENSTOWN**

  
**OLIVE**



**MSR QUEENSTOWN, CHINCHWAD**



**MSR CAPITAL, PIMPRI**



**MSR SQUARE, CHINCHWAD**



**MSR OLIVE, KATRAJ**



# MORE OF COSY MOMENTS...

Just like the Winter season brings cool and comforting days, imagine waking up to a mesmerising view and the sweet sound of the birds chirping. Gift your days a soothing start at homes nestled in the lap of nature. Nature's unbeatable beauty will surround your dream home, ensuring a balanced lifestyle.

**Live in homes as wonderful as Winters!**



# FLOOR PLANS



**SALABLE AREA STATEMENT**

**C Wing**

UNIT NO.	BHK	CARPET AREA IN SQ. MT.	BALCONY AREA IN SQ. MT.	TERRACE AREA IN SQ. MT.	TOTAL CARPET AREA SQ. MT.	TOTAL CARPET AREA SQ. FT.
101,102	1.5	43.74	4.74	9.60	58.08	625
103,303,503,703,903,1103	3	68.52	11.82	9.79	90.14	970
104	2	50.22	10.85	12.56	73.63	793
301,302,501,502,701,702,901,902,1101,1102	2	56.61	4.75	12.51	73.87	795
304,504,704,904,1104	2	51.52	9.53	12.56	73.61	792

**TYPICAL ODD FLOOR PLAN**

Facing Inward (QueensTown)

Facing Outward (Lokmanya)

1st, 3rd, 5th, 7th, 9th, 11th

Unit Conversion  
1 Sq.Mts = 10.764 Sq. Ft.  
1 Feet = 0.3048 Mts

\*For Presentation Purpose Only

**D Wing**

UNIT NO.	BHK	CARPET AREA IN SQ. MT.	BALCONY AREA IN SQ. MT.	TERRACE AREA IN SQ. MT.	TOTAL CARPET AREA SQ. MT.	TOTAL CARPET AREA SQ. FT.
101	3	69.50	10.87	9.79	90.13	970
101,301,701,901,1101	3	69.16	11.18	9.79	90.14	970
102,302,502,702,902,1102	3	67.80	12.55	9.79	90.14	970
103,104	1.5	43.74	4.74	9.60	58.08	625
303,503,703,903,1103	2	56.61	4.75	12.51	73.87	795
304,504,704,904,1104	2	51.52	9.53	12.56	73.61	792



**SALABLE AREA STATEMENT**

**A Wing**

UNIT NO.	BHK	CARPET AREA IN SQ. MT.	BALCONY AREA IN SQ. MT.	TERRACE AREA IN SQ. MT.	TOTAL CARPET AREA SQ. MT.	TOTAL CARPET AREA SQ. FT.
201,401,1001,1002,1201	2	56.18	5.18	12.67	74.03	797
203,403,1003	3	67.21	13.01	9.84	90.06	969
204	3	67.80	12.37	9.84	90.06	969
1203	3 - P/H	67.80	12.38	78.69	158.87	1,710
1204	3 - P/H	70.63	10.51	78.69	159.83	1,720

**TYPICAL EVEN FLOOR PLAN**

Facing Inward (QueensTown)

Facing Outward (Lokmanya)

2nd, 4th, 6th, 8th, 10th, 12th

**B Wing**

UNIT NO.	BHK	CARPET AREA IN SQ. MT.	BALCONY AREA IN SQ. MT.	TERRACE AREA IN SQ. MT.	TOTAL CARPET AREA SQ. MT.	TOTAL CARPET AREA SQ. FT.
202,1002	3	66.21	13.96	9.84	90.01	969
204,404,1003,1004,1204	2	56.18	5.18	12.67	74.03	797
1001,1201	2	55.11	5.94	12.67	73.72	794
1003	2	56.18	5.18	12.67	74.03	797
1202	3 - P/H	68.41	11.82	78.69	158.92	1,711

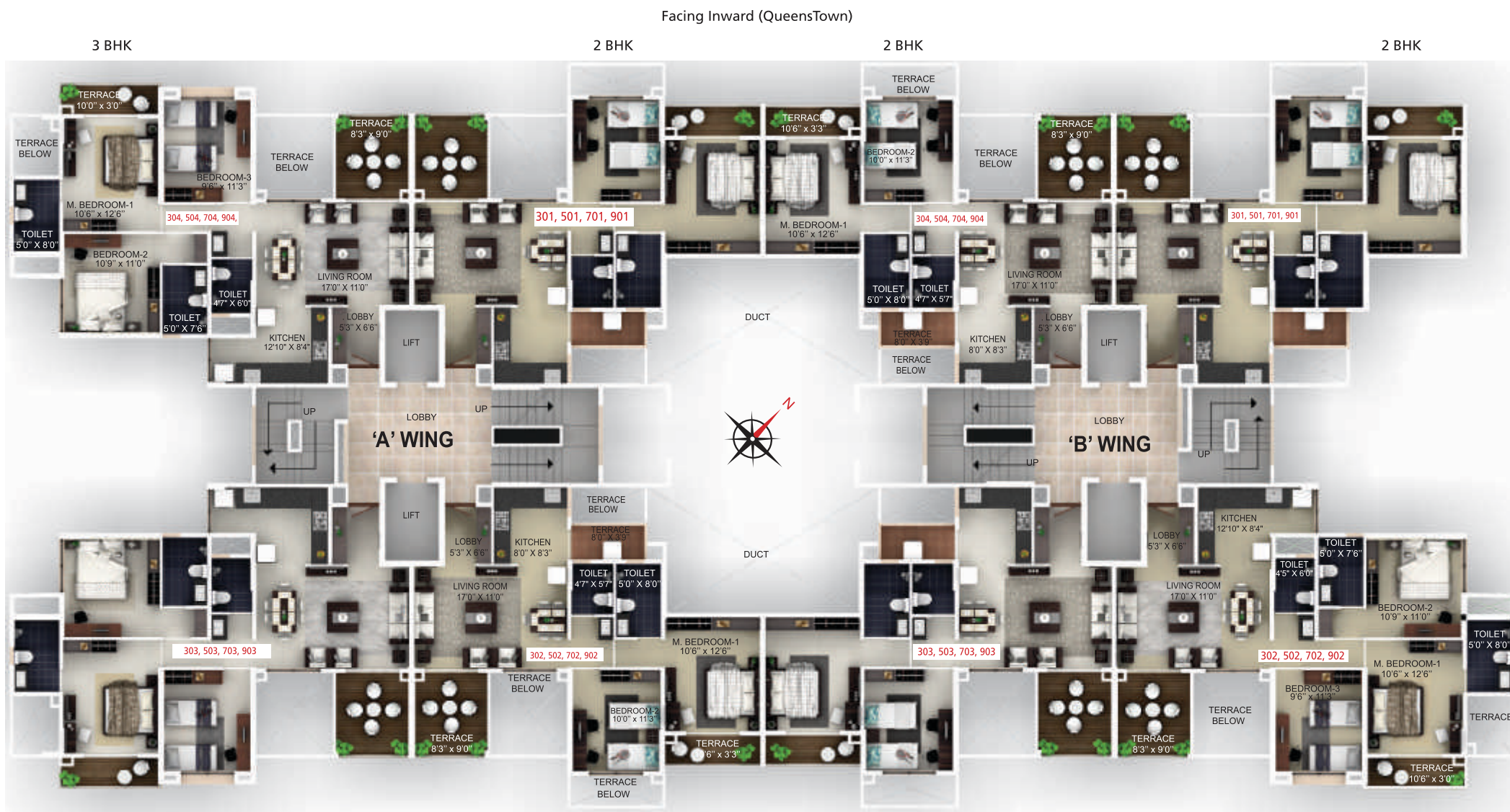

SALABLE AREA STATEMENT

UNIT NO.	BHK	CARPET AREA IN SQ. MT.	BALCONY AREA IN SQ. MT.	TERRACE AREA IN SQ. MT.	TOTAL CARPET AREA SQ. MT.	TOTAL CARPET AREA SQ. FT.
101,102	1.5	43.74	4.74	9.60	58.08	625
103,303,1103	3	67.80	12.55	9.79	90.14	970
104	3	69.50	10.87	9.79	90.14	970
302,502,1101,1102	2	56.61	4.75	12.51	73.87	795
1104	3	69.16	10.87	9.79	90.14	970

TYPICAL ODD FLOOR PLAN

1st, 3rd, 5th, 7th, 9th, 11th

UNIT NO.	BHK	CARPET AREA IN SQ. MT.	BALCONY AREA IN SQ. MT.	TERRACE AREA IN SQ. MT.	TOTAL CARPET AREA SQ. MT.	TOTAL CARPET AREA SQ. FT.
101	2	50.22	10.85	12.56	73.63	793
102,702,1102	3	68.52	11.82	9.79	90.13	970
103,104	1.5	43.74	4.74	9.60	58.08	625
301,501,701,901,1101	2	51.22	9.53	12.56	73.31	789
304,704,903,904,1103,1104	2	56.61	4.75	12.51	73.87	795

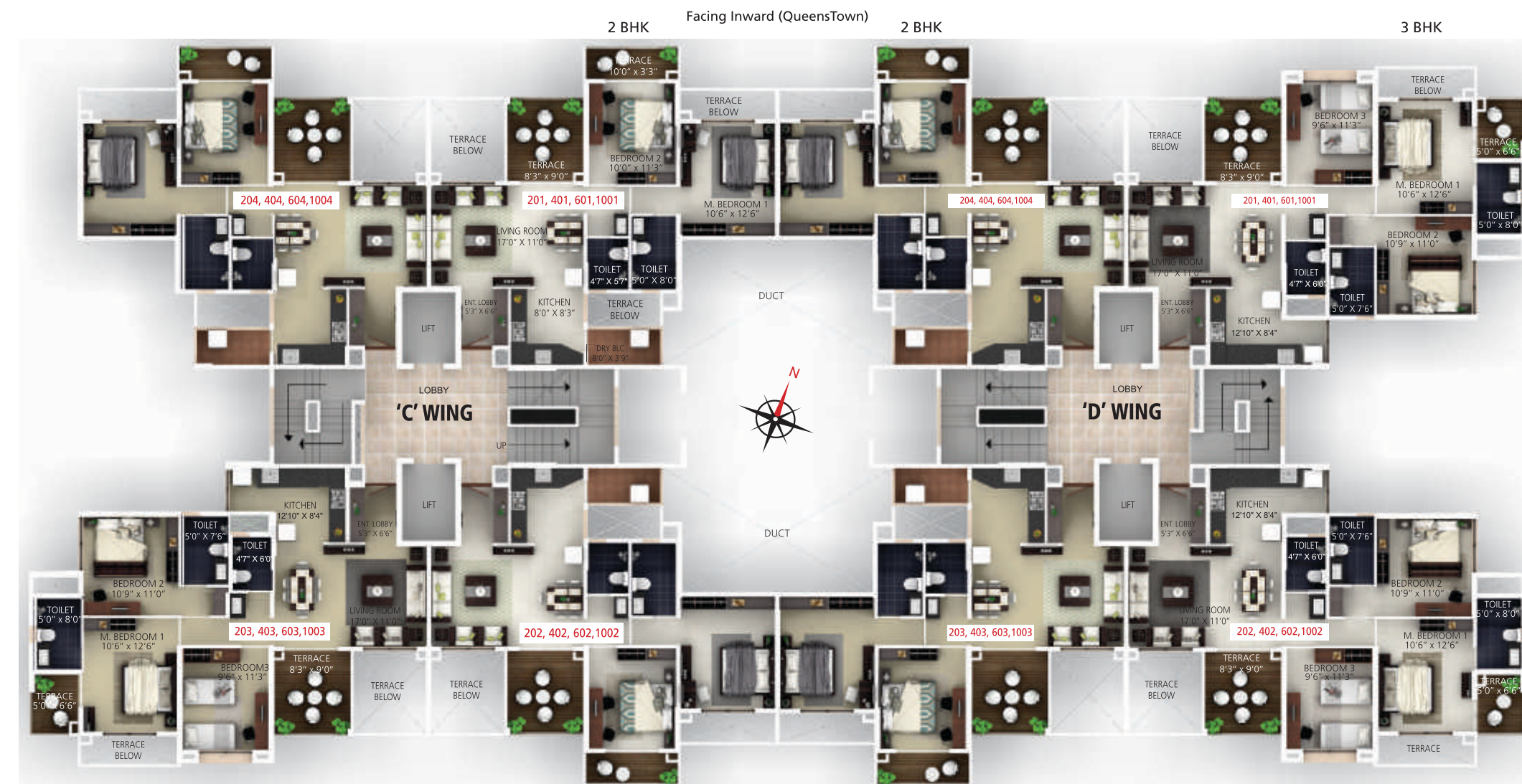

SALABLE AREA STATEMENT

UNIT NO.	BHK	CARPET AREA IN SQ. MT.	BALCONY AREA IN SQ. MT.	TERRACE AREA IN SQ. MT.	TOTAL CARPET AREA SQ. MT.	TOTAL CARPET AREA SQ. FT.
201,202,401,402,601,602,801,1001,1002,1201	2	56.18	5.18	12.67	74.03	797
203,403,603,1003	3	66.21	13.96	9.84	90.01	969
204,404,604,804,1004,1204	2	55.11	5.94	12.67	73.72	794
803	3	68.41	11.82	9.84	90.07	970
1203	3-P/H	68.41	11.82	78.69	158.92	1,711

TYPICAL EVEN FLOOR PLAN

2nd, 4th, 6th, 8th, 10th, 12th

UNIT NO.	BHK	CARPET AREA IN SQ. MT.	BALCONY AREA IN SQ. MT.	TERRACE AREA IN SQ. MT.	TOTAL CARPET AREA SQ. MT.	TOTAL CARPET AREA SQ. FT.
201,401,601,801,802,1001	3	67.80	12.37	9.84	90.01	969
202,402,602,1002	3	67.21	13.01	9.84	90.06	969
203,403,603,1003,204,404,604,804,1004,1204	2	56.18	5.18	12.67	74.03	797
1201	3-P/H	70.63	10.51	78.69	159.83	1,720
1202	3-P/H	67.80	12.38	78.69	158.87	1,710

# LOCATION

## CHINCHWAD, A NEIGHBOURHOOD OF CELEBRATIONS!

Chinchwad is one of the most rapidly developing locales in Pune with all the comfort and convenience of a modern lifestyle. Schools, hospitals and convenience stores are located strategically, ensuring easy access to everything you and your loved ones would need.

